



Australian Government

Department of Health, Disability and Ageing

Principle 4 - Connect with Community:
National Aged Care Design Principles and Guidelines



Australian Government

Department of Health, Disability and Ageing

Principle 4 - Connect with Community: National Aged Care Design Principles and Guidelines

Webinar Series: Home Matters - Rethinking Aged Care Design



Acknowledgment of Country

The Department of Health, Disability and Ageing and Dementia Training Australia would like to show our respect and acknowledge the traditional custodians of these lands. We extend this respect to Elders past and present, and to all Aboriginal and Torres Strait Islander people here today.



Artist: Brittney Angus

Housekeeping



Q&A



Participant
Audio/Video



Copy of Slides

Overview of Today's Session

- Encouraging a connection with family, friends and community
- Guidelines on cafes and neighbourhood engagement
- Strategies for maintaining participation in meaningful communal activities.



Host



Nick Seemann
Environments Specialist

Speakers



Martin Rix

CEO
Belong Villages UK



Liz Fuggle

Associate & Strategy Lead
Constructive Dialogue Architects



Sr Grace Roclawaska

Director of Mission
Holy Family Services

National Aged Care Design Principles and Guidelines

and how they can help improve residents' lives





Principle 1 - Enable the Person

To support people living in a place that maintains their health, wellbeing and sense of identity.

Principle 2 - Cultivate a Home

To create a familiar environment in which people have privacy, control and feel they belong.

Principle 3 - Access the Outdoors

To support people seeing, accessing and spending time outdoors in contact with nature.

Principle 4 - Connect with Community

To encourage people to connect with family, friends and community, continuing to participate in meaningful activities.

National Aged Care Design Principles and Guidelines. Commonwealth of Australia, Department of Health Disability & Ageing 2024.

Principle 4 Guidelines

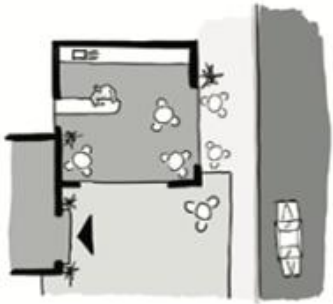

4.1 Neighbourhood Access

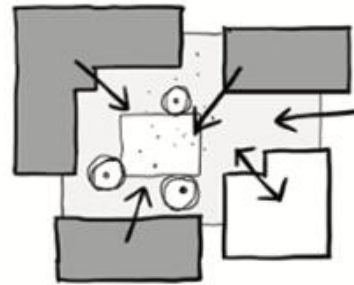

4.2 Community Hub

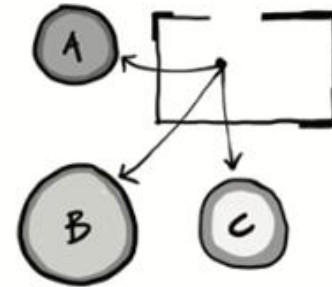

4.3 Easy Navigation to Households



4.4 Integrated Building Form

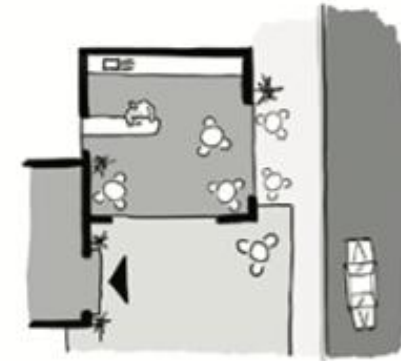

Guideline 4.1 – Neighbourhood Access



Concept design by Monash Urban Lab with NMBW Architecture Studio, BoardGrove Architects, BLOXAS and Glas Landscape Architects

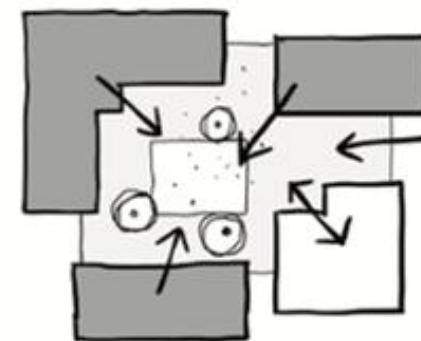

Guideline 4.2 – Community Hub

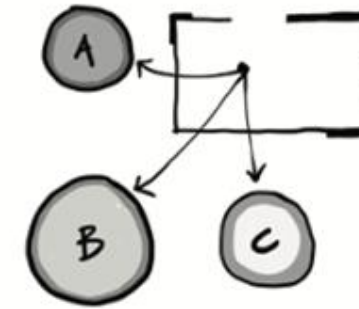

Guideline 4.3 – Easy Navigation to Households



Concept design by Mark Boffa, Guruge Ruwani Dharmasiri, Pulasthi Wijekoon, Jana Osvald and Julie Ockerby

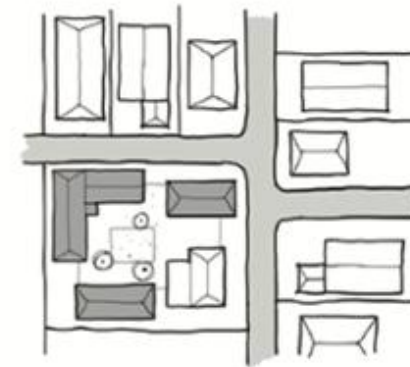

Guideline 4.4 – Integrated Building Form









Our History

The Sisters of the Holy Family of Nazareth came to Marayong in 1954 taking a central role in caring for Polish migrant families displaced by the Second World War.









**Holy Family
Services**

A Ministry of the Sisters of the Holy Family of Nazareth

Care Home Assessment Tool (CHAT)



- **What does it do?**
 - Guides you through the 4 Design Principles
 - Assesses how well your care home meets each Guideline
 - Identifies strengths and areas for improvement
 - Provides a holistic site report (by unit/wing/household)

<https://dta.com.au/care-home-assessment-tool-chat/>

Environments Hub



Q&A Discussion

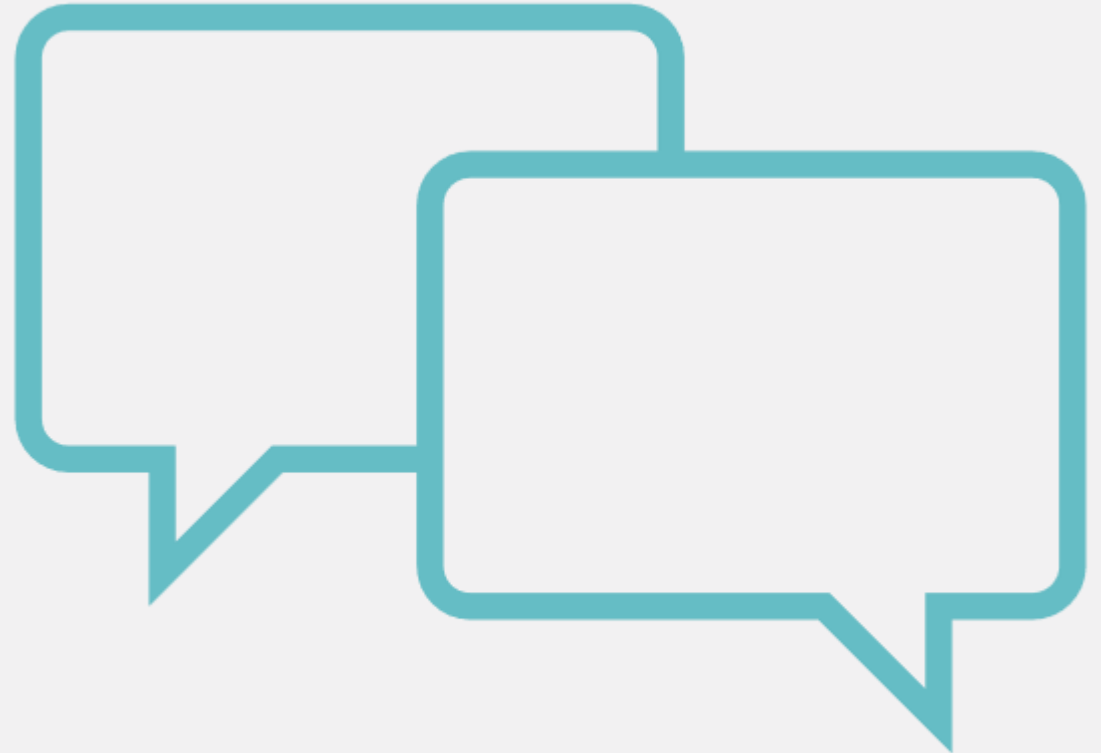

Photo Credits

1. Concept design by Monash Urban Lab with NMBW Architecture Studio, BoardGrove Architects, BLOXAS and Glas Landscape Architects (slide 11)
2. The Village by Scalabrini (slide 12)
3. Harbison Burradoo (slide 13)
4. Concept design by Mark Boffa, Guruge Ruwani Dharmasiri, Pulasthi Wijekoon, Jana Osvald and Julie Ockerby (slide 13)
5. Uniting Aldersgate Lilyfield (slide 14)
6. Belong Villages, UK (slides 15-18)
7. Holy Family Services Marayong (slides 19-22)



health.gov.au/aged-care-reforms



Phone **1800 200 422**
(My Aged Care's free call phone line)